



CWFL Series

Fiber Laser Chiller Series



Fiber Laser Chiller Selection Guide

MODEL	Temperature Precision	Rate Flow	Max. Pump Pressure	Refrigerant	Applicable fiber laser power
CWFL-1000	±0.5°C	2L/min + >12L/min	36~53M	R-410a	1000W
CWFL-1500	±0.5°C	2L/min + >15L/min	36~53M	R-410a	1500W
CWFL-2000	±0.5°C	2L/min + >15L/min	44~53M	R-410a	2000W
CWFL-3000	±0.5°C	2L/min + >20L/min	50~59M	R-410a	3000W
CWFL-4000	±1°C	2L/min + >40L/min	50~59M	R-410a	4000W
CWFL-6000	±1°C	2L/min + >50L/min	59~61.5M	R-410a	6000W
CWFL-8000	±1°C	2L/min + >65L/min	59~61.5M	R-410a	8000W
CWFL-12000	±1°C	2.5L/min + >100L/min	72~75M	R-410a	12000W
CWFL-20000	±1°C	150L/min	64.5M	R-410a	20000W
CWFL-30000	±1°C	10L/min + 250L/min	76~81M	R-407c	30000W
CWFL-40000	±1°C	10L/min + 350L/min	86M	R-407c	40000W
CWFL-60000	±1°C	10L/min + 500L/min	53M	R-407c	60000W
RMFL-1500 机柜式 Rack mount	±0.5°C	2L/min + >10L/min	40M	R-410a	1000W-1500W
RMFL-2000 机柜式 Rack mount	±0.5°C	2L/min + >15L/min	40M	R-410a	2000W
RMFL-3000 机柜式 Rack mount	±0.5°C	2L/min + >25L/min	40M	R-410a	3000W
CWFL-1500ANW	±1°C	1L/min + >10L/min	40M	R-410a	1500W
CWFL-2000ANW	±1°C	2L/min + >15L/min	40M	R-410a	2000W
CWFL-3000ENW	±1°C	2L/min + >20L/min	44~53M	R-410a	3000W

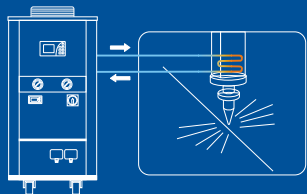

For Fiber Laser Cooling

By cooling the laser device, our industrial chiller can keep laser output power stable and ensure light beam quality to improve the working life and cutting accuracy of the laser device.

Fiber Laser Chiller

CWFL-1000
CWFL-1500
CWFL-2000



TEYU CWFL Series Water Chiller Features:

1. Specifically designed for fiber lasers;
2. Temperature stability covers $\pm 0.5^{\circ}\text{C}$ and $\pm 1^{\circ}\text{C}$ for better water temperature control and stability;
3. With dual independent temperature control mode (high & low temperatures). Low temperature control mode for cooling the fiber laser while high temperature control mode for cooling laser head;
4. Provide stable and reliable cooling for fiber laser machine.



Premium axial fan
Quiet, efficient heat dissipation
Maintenance-free

Fiber Laser Chiller

CWFL-3000
CWFL-4000
CWFL-6000



Support RS-485 communication
Real-time monitoring and remote control

MODEL	CWFL-1000		CWFL-1500		CWFL-2000	
	CWFL-1000ANPTY	CWFL-1000BNPTY	CWFL-1500ANPTY	CWFL-1500BNPTY	CWFL-2000ANPTY	CWFL-2000BNPTY
Voltage	AC 1P 220~240V		AC 1P 220~240V		AC 1P 220~240V	
Frequency	50Hz	60Hz	50Hz	60Hz	50Hz	60Hz
Current	2.5~12.1A	3.9~13A	2.5~16.9A	3.9~17.5A	3.4~17.8A	3.9~17.3A
Max. power consumption	2.21kW	2.56kW	2.65kW	2.68kW	3.03kW	3.18kW
Heater power	600W + 600W		400W + 600W		600W + 600W	
Precision	$\pm 0.5^{\circ}\text{C}$		$\pm 0.5^{\circ}\text{C}$		$\pm 0.5^{\circ}\text{C}$	
Reducer	Capillary		Capillary		Capillary	
Pump power	0.37kW	0.75kW	0.37kW	0.75kW	0.55kW	0.75kW
Tank capacity	14L		14L		14L	
Inlet and outlet	Rp1/2"+Rp1/2"		Rp1/2"+Rp1/2"		Rp1/2"+Rp1/2"	
Max. pump pressure	36M	53M	36M	53M	44M	53M
Rated flow	2L/min + >12L/min		2L/min + >15L/min		2L/min + >15L/min	
N.W.	63Kg	66Kg	70Kg	70Kg	75Kg	70Kg
G.W.	75Kg	76Kg	82Kg	82Kg	87Kg	82Kg
Dimension	70 X 47 X 89 cm (L X W X H)		70 X 47 X 89cm (L X W X H)		70 X 47 X 89cm (L X W X H)	
Package dimension	73 X 56 X 105 cm (L X W X H)		73 X 56 X 105cm (L X W X H)		73 X 56 X 105cm (L X W X H)	

Note: The working current can be different under different working conditions. The above information is for reference only. Please subject to the actual delivered product.

MODEL	CWFL-3000			CWFL-4000		CWFL-6000	
	CWFL-3000ANPTY	CWFL-3000BNPTY	CWFL-3000ENPTY	CWFL-4000BNPTY	CWFL-4000ENPTY	CWFL-6000ENPTY	CWFL-6000FNPTY
Voltage	AC 1P 220~240V			AC 3P 380V	AC 1P 220~240V	AC 3P 380V	AC 3P 380V
Frequency	50Hz	60Hz	50 Hz	60Hz	50Hz	60Hz	60Hz
Current	5.0~26.9A	3.6~24.5A	2.1~10.3A	3.6~23.7A	1.7~13.4A	2.1~15.7A	2.1~13.5A
Max. power consumption	4.36kW	4.65kW	4.68kW	5.5kW	6.36kW	7.66kW	7.27kW
Heater power	600W + 1400W			600W + 1800W		600W + 1800W	
Precision	$\pm 0.5^{\circ}\text{C}$			$\pm 1^{\circ}\text{C}$		$\pm 1^{\circ}\text{C}$	
Reducer	Capillary			Capillary		Capillary	
Pump power	0.75kW	1kW	0.75kW	1kW	0.75kW	1.1kW	1kW
Tank capacity	22L			40L		70L	
Inlet and outlet	Rp1/2"+Rp1"			Rp1/2"+Rp1"		Rp1/2"+Rp1"	
Max. pump pressure	50M	59M	50M	59M	50M	61.5 M	59M
Rated flow	2L/min + >20L/min			2L/min + >40L/min		2L/min + >50L/min	
N.W.	93Kg	87Kg	105Kg	123Kg	135Kg	181Kg	178Kg
G.W.	109Kg	103Kg	121Kg	150Kg	154Kg	206Kg	203Kg
Dimension	77 X 55 X 103cm (L X W X H)			87 X 65 X 117cm (L X W X H)		105 X 71 X 133cm (L X W X H)	
Package dimension	78 X 65 X 117cm (L X W X H)			95 X 77 X 135cm (L X W X H)		112 X 82 X 150cm (L X W X H)	

Note: The working current can be different under different working conditions. The above information is for reference only. Please subject to the actual delivered product.

Fiber Laser Chiller

CWFL- 8000
 CWFL- 12000
 CWFL- 20000
 CWFL- 30000

- Energy Saving
- Overcurrent Protection For Compressor
- Flow Alarm
- Ultra-Precise Temp Control
- Dual Temp Control
- Double-effect Heating



 Support RS-485 communication
 Real-time monitoring and remote control

MODEL	CWFL-8000		CWFL-12000	
	CWFL-8000ENPTY	CWFL-8000FNPTY	CWFL-12000ENPTY	CWFL-12000FNPTY
Voltage	AC 3P 380V	AC 3P 380V	AC 3P 380V	AC 3P 380V
Frequency	50Hz	60Hz	50Hz	60Hz
Current	2.1~17.9A	2.1~16.5A	4.3~30.9A	4.1~23.5A
Max. power consumption	8.94kW	8.64kW	14.72kW	14.94kW
Heater power	600W + 2400W		600W + 3600W	
Precision	±1°C		±1°C	
Reducer	Capillary		Capillary	
Pump power	1.1kW	1kW	2.2kW	3.0kW
Tank capacity	87L		170L	
Inlet and outlet	Rp1/2" + Rp1"		Rp1/2" + Rp1-1/4"	
Max. pump pressure	61.5M	59M	75M	72M
Rated flow	2L/min +>65L/min		2.5L/min +>100L/min	
N.W.	198Kg	200Kg	306Kg	308Kg
G.W.	226Kg	228Kg	348Kg	348Kg
Dimension	120 X 64 X 116cm (L X W X H)		155 X 80 X 135cm (L X W X H)	
Package dimension	135 X 84 X 137cm (L X W X H)		170 X 101 X 152cm (L X W X H)	

Note: The working current can be different under different working conditions. The above information is for reference only. Please subject to the actual delivered product.

MODEL	CWFL-20000	CWFL-30000	
	CWFL-20000ETTY	CWFL-30000ETTY	CWFL-30000FTTY
Voltage	AC 3P 380V	AC 3P 380V	AC 3P 380V
Frequency	50Hz	50Hz	60Hz
Current	5.8~34A	10.65~53.75A	7.84~45.84A
Max. power consumption	17.28kW	27.19kW	25.75kW
Heater power	1000W + 4800W	1800W + 10800W	
Precision	±1°C	±1°C	
Reducer	Capillary	Capillary	
Pump power	3kW	5.5kW	
Tank capacity	170L	330L	
Inlet and outlet	Rp1/2" + Rp1-1/2"	Rp1/2" + Rp2"	
Max. pump pressure	64.5M	81M	76M
Rated flow	150L/min	10L/min + 250L/min	
N.W.	424Kg	753Kg	
G.W.	483Kg	967Kg	
Dimension	150 X 108 X 158cm (L X W X H)	228 X 112 X 190cm (L X W X H)	
Package dimension	162 X 123 X 177cm (L X W X H)	235 X 137 X 214cm (L X W X H)	

Note: The working current can be different under different working conditions. The above information is for reference only. Please subject to the actual delivered product.

光纤激光冷水机 Fiber Laser Chiller

CWFL-40000
CWFL-60000



- 
Energy Saving
- 
Overcurrent Protection For Compressor
- 
Flow Alarm
- 
Ultra-Precise Temp Control
- 
Dual Temp Control
- 
Double-effect Heating



Support RS-485 communication
Real-time monitoring and remote control

MODEL	CWFL-40000
	CWFL-40000ETTY
Voltage	AC 3P 380V
Frequency	50Hz
Current	15~72.9A
Max. power consumption	35.82kW
Heater power	10800W+1800W
Precision	±1°C
Reducer	Capillary
Pump power	7.5kW
Tank capacity	536L
Inlet and outlet	Rp1/2" + Rp2"
Max. pump pressure	86M
Rated flow	10L/min+350L/min
N.W.	923Kg
G.W.	1210Kg
Dimension	286 X 113 X 190cm (L X W X H)
Package dimension	295 X 137 X 214cm (L X W X H)

Note: The working current can be different under different working conditions. The above information is for reference only. Please subject to the actual delivered product.

MODEL	CWFL-60000
	CWFL-60000ETTY
Voltage	AC 3P 380V
Frequency	50Hz
Current	2.1~6.9A
Max. power consumption	53.88kW
Heater power	10800W+1800W
Precision	±1°C
Reducer	Capillary
Pump power	4.4kW+4.4kW
Tank capacity	600L
Inlet and outlet	Rp1/2" + Rp1"
Max. pump pressure	53M
Rated flow	10L/min+500L/min
N.W.	1292kg
G.W.	1650kg
Dimension	343 X 139 X 190cm (L X W X H)
Package dimension	347 X 163 X 214cm (L X W X H)

Note: The working current can be different under different working conditions. The above information is for reference only. Please subject to the actual delivered product.